

Profil A-A

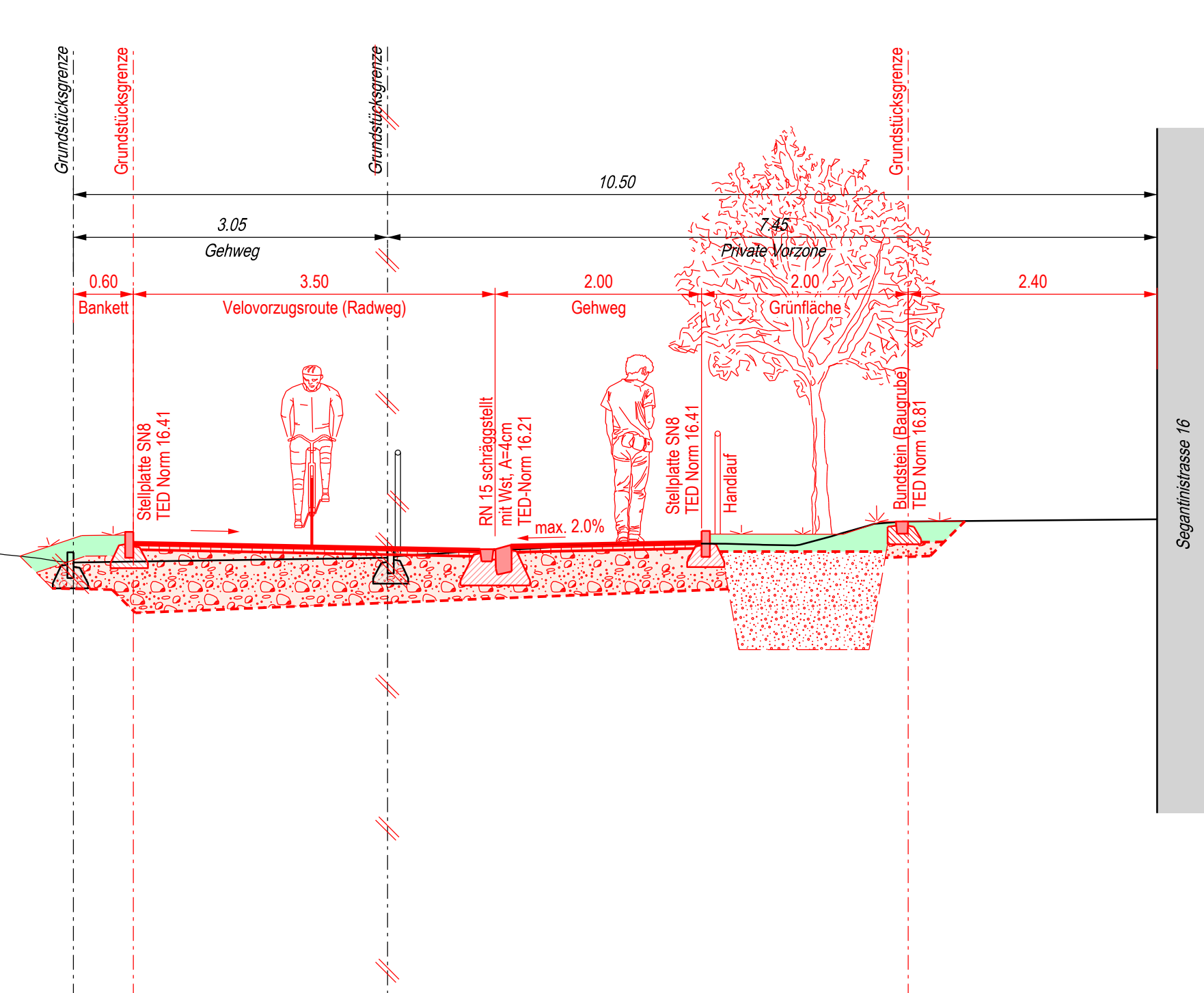

Profil B-B

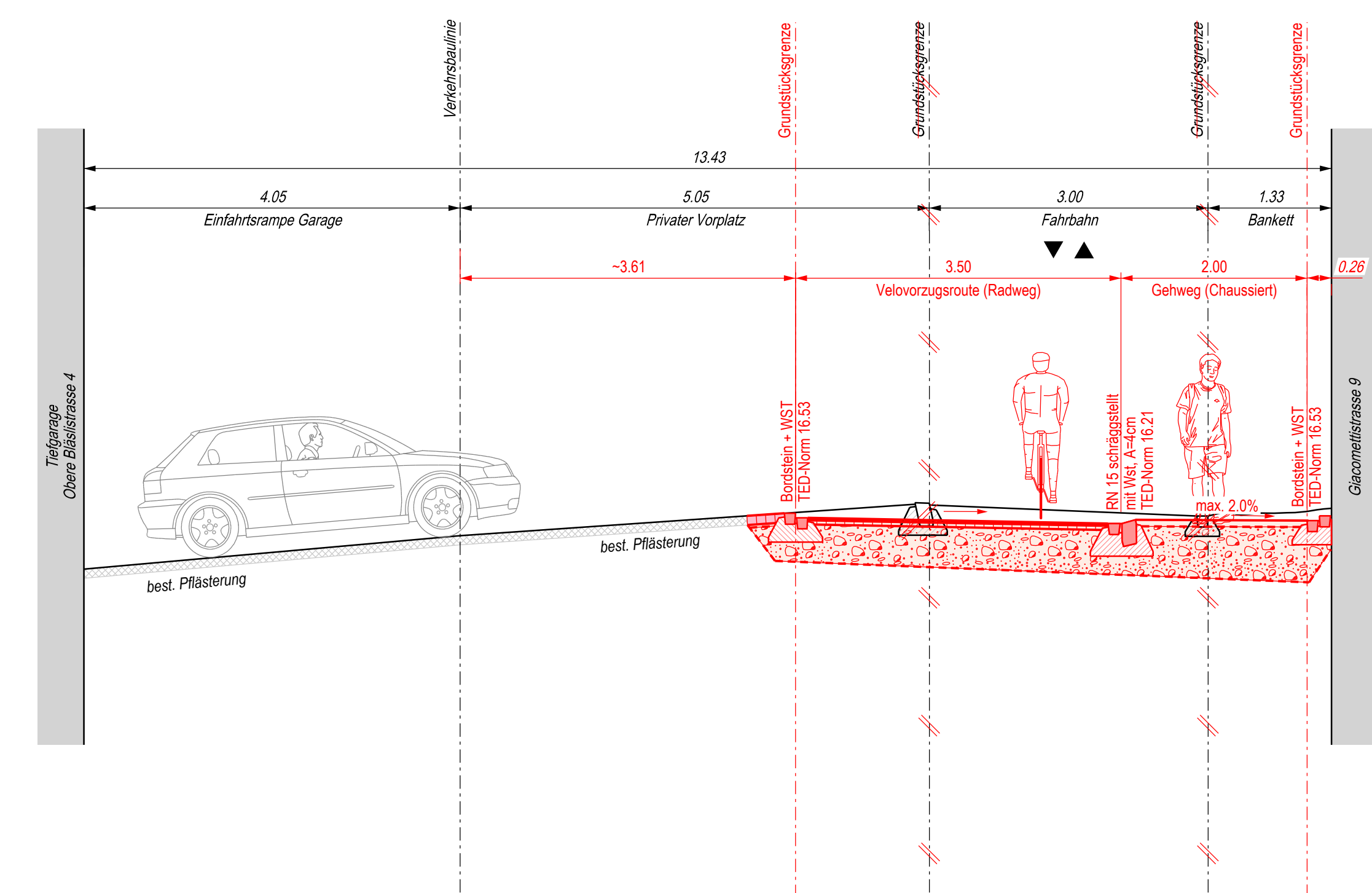

Profil C-C

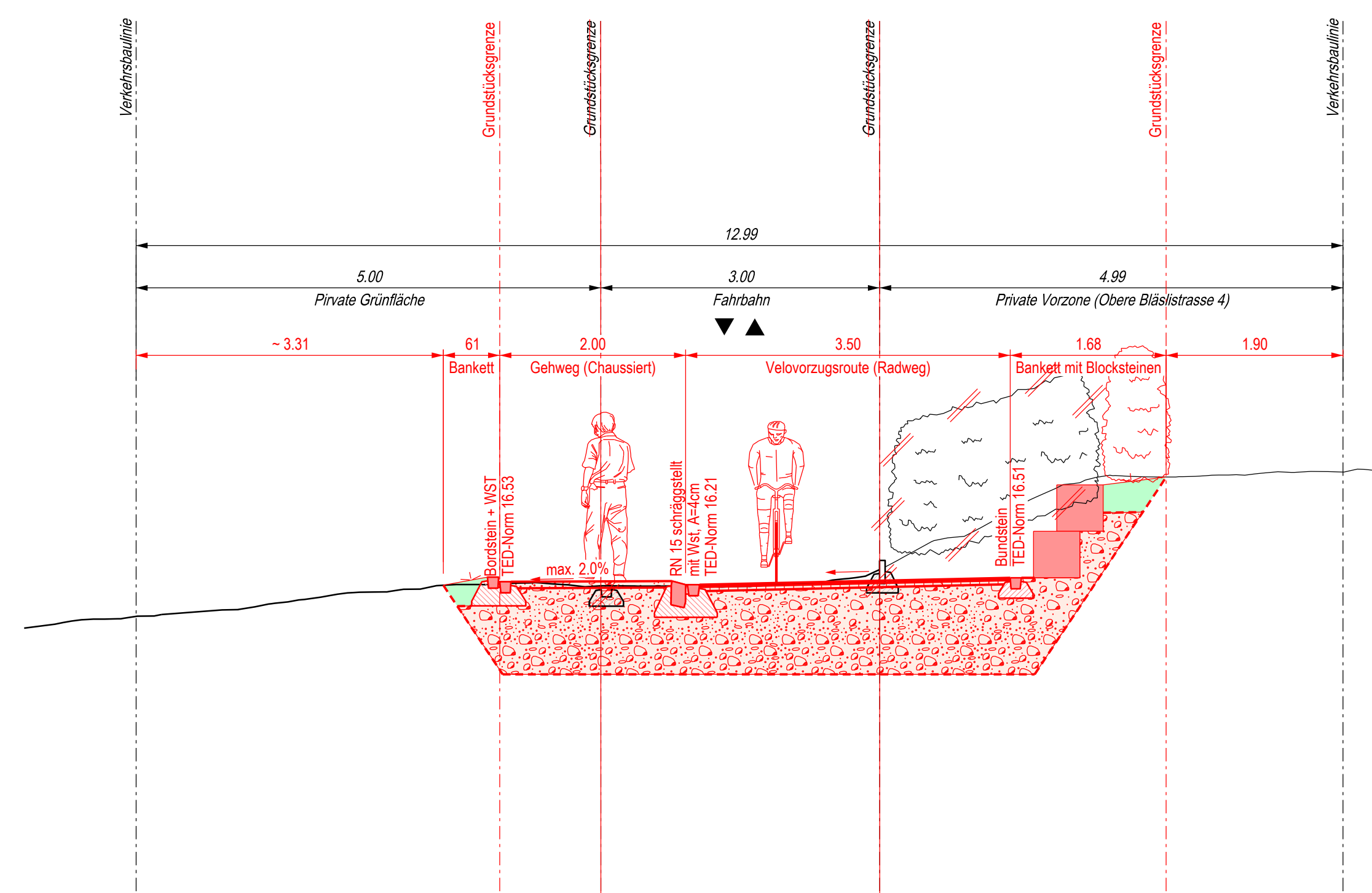

Profil D-D

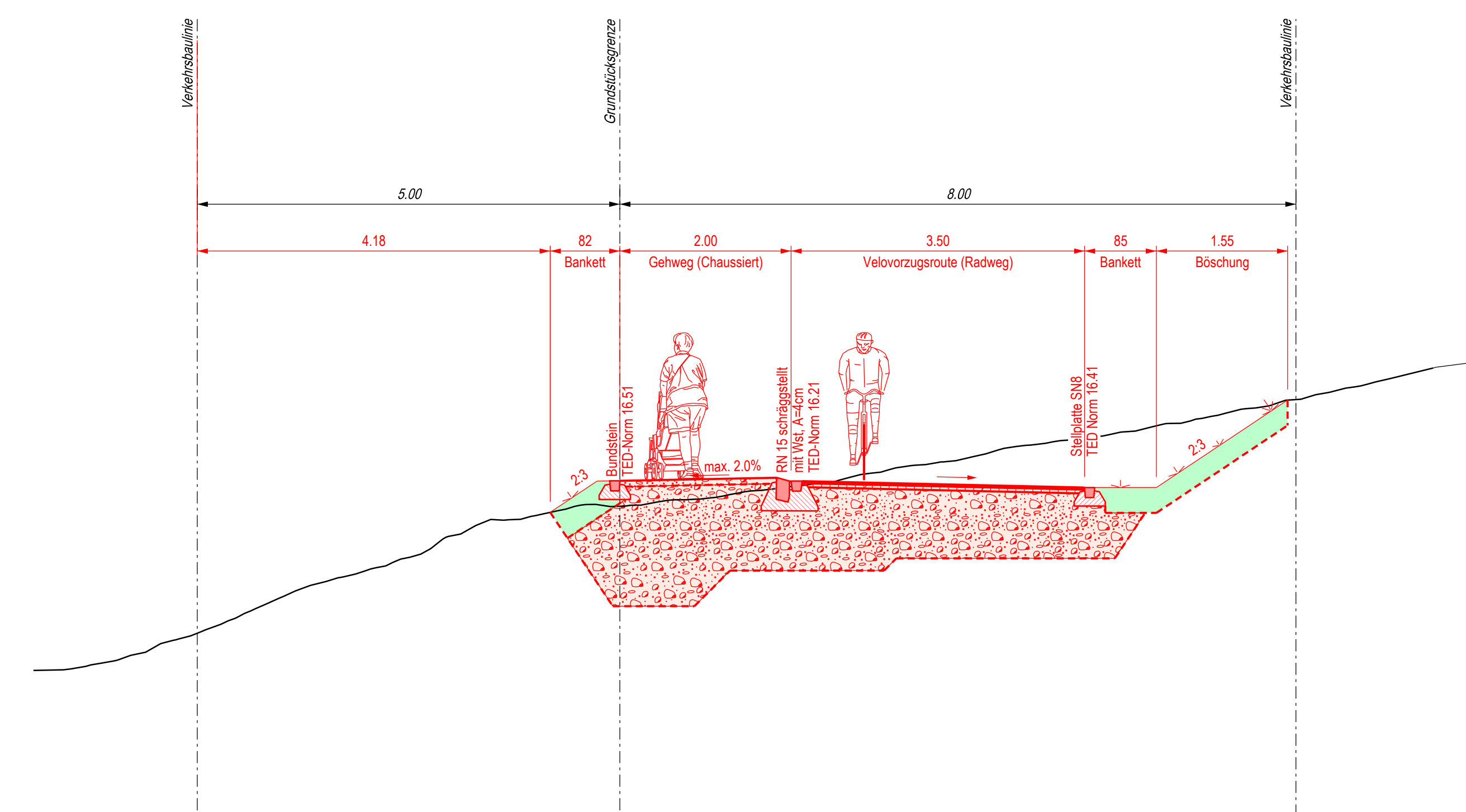

Profil E-E

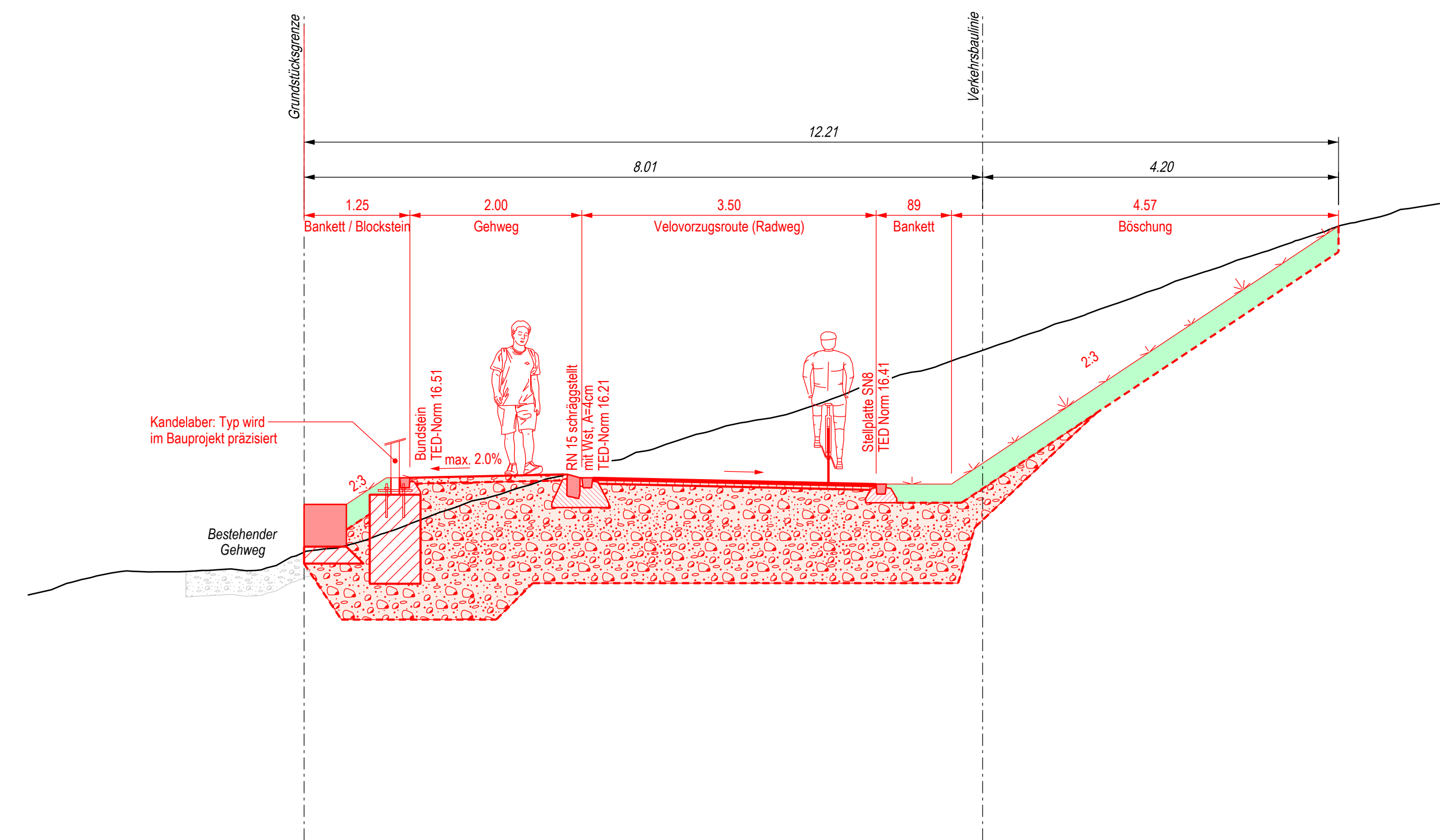

Profil F-F

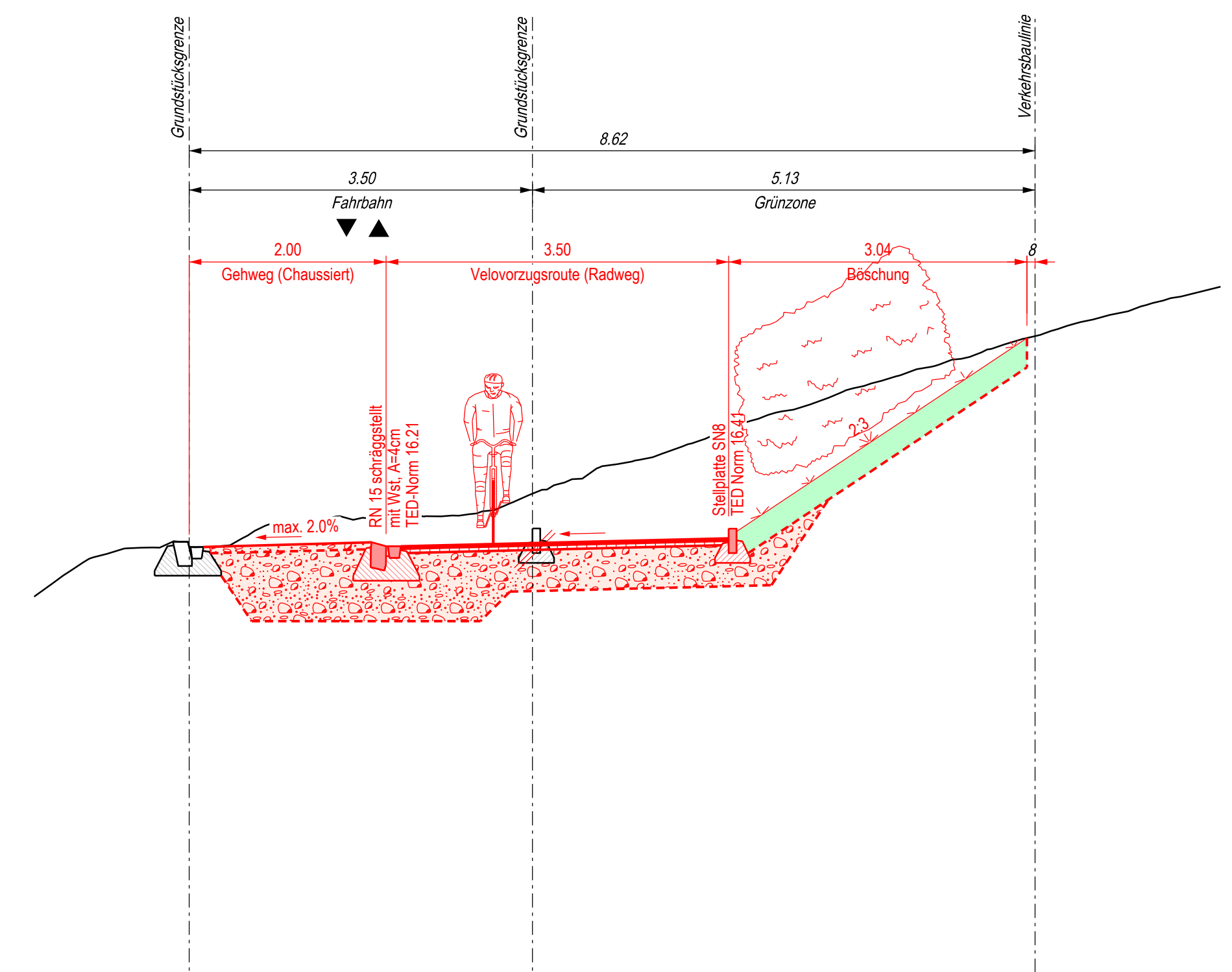

Profil G-G

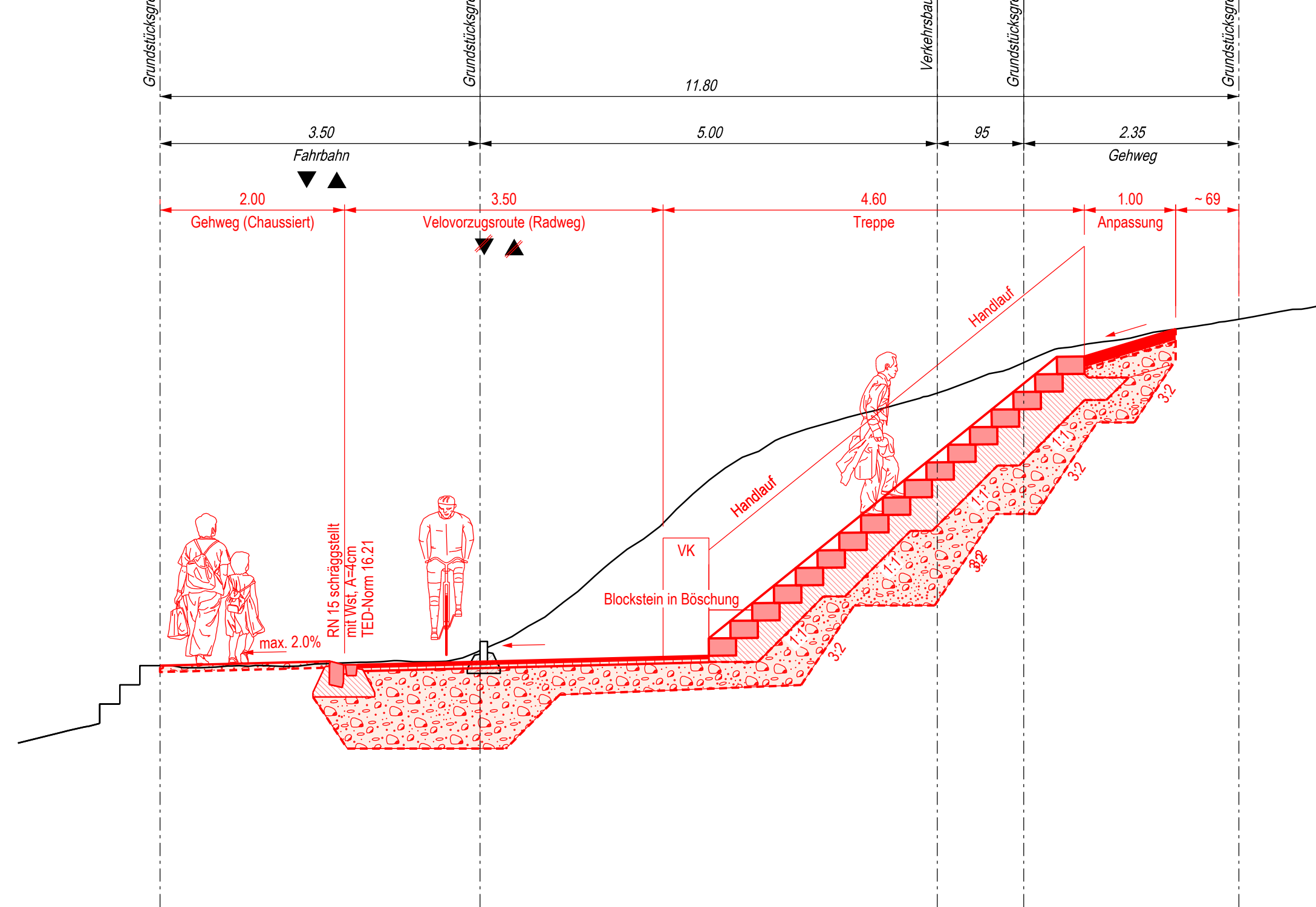

Profil H-H

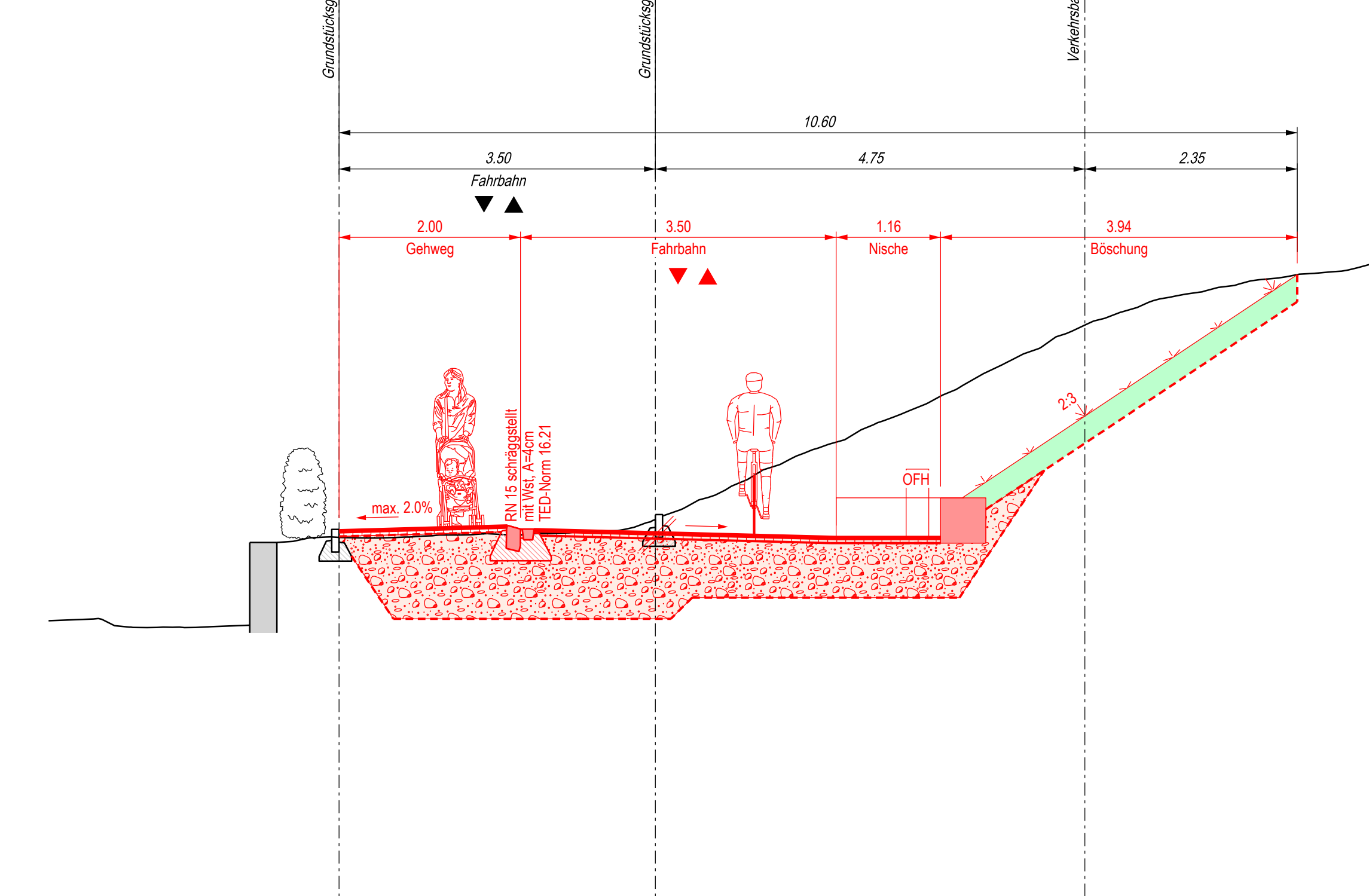

**Stadt Zürich Tiefbauamt** Vorprojekt Appenzellerweg

Auflageplan gemäss §13 StrG

Normalprofile 1 : 50

Projektant durch <b>HEERLI</b> Ingenieur- und Architekturbüro Hohlweg 24 8003 Zürich Tel. 044 390 31 11 www.heerli.ch	Ausfertigung für TAZ Bau - Nr. <b>23007</b>	Plan - Nr. <b>23007 - 21</b>
Bearb. / Gepr. rc & FF / cr	Datum <b>08.01.2026</b>	Format 60 / 147
TAZ Projektleitung am	Änderungen	Datengrafik © Projekt 13334 - TAZ Appenzellerweg 23007/01 CAD- Projekt12_vorP_xbatt/Planer13334_2_31_51_QP_§13-Ebenen.dwg

Von Direktorin genehmigt, TAZ-Projektleitung: